

## RS 36 series

- Small foot print
- Synchro-Flange mounting
- Solid shaft
- Line counts up to 3,600
- Typically used for motor feedback, rotational speed control, and robotics



### Compatible with:

- Heidenhain ROD 100 series - ROD 1020, ROD 1080, and ROD 1070

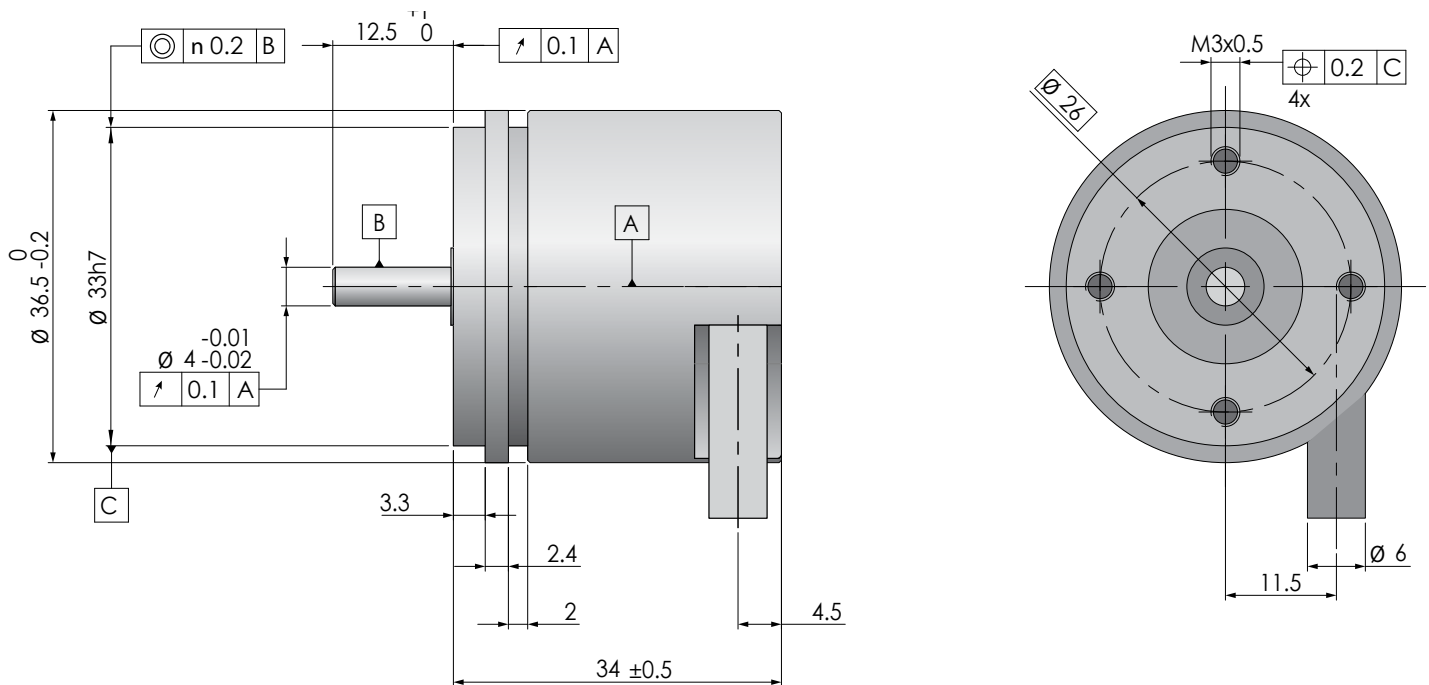

# RS 36 series

	RS 3601	RS 3602	RS 3605	RS 3610	RS3600
<b>Line count</b>	1000, 1024, 2048, 2500, 3600				
<b>Pulses per revolution</b>	1x line count	2x line count	5x line count	10x line count	1x line count
<b>Output Signal</b>	TTL/RS422				1 Vpp
<b>Max. output frequency</b>	≥ 160 kHz	≥ 320 kHz	≥ 800 kHz	≥ 1 MHz	≥ 180 kHz
<b>Max. mechanical speed</b>	10,000 RPM				
<b>Accuracy grade</b>	1/10th of the grating period				
<b>Reference mark</b>	Single				
<b>Max. axial load</b>	0.5 kg				
<b>Max. radial load</b>	1 kg				
<b>Supply voltage</b>	5 V ± 5%				
<b>Supply current (without load)</b>	≤ 120 mA				
<b>Outlet type</b>	Cable or housing connector (12 pin round)				
<b>Max. cable length</b>	100 m				150 m
<b>Environmental protection</b>	IP64 (IEC 60529)				
<b>Operating temperature range*</b>	-20°C...+70°C				
<b>Storage temperature range</b>	-30°C...+80°C				
<b>Humidity</b>	98% (non-condensing)				
<b>Vibration (55 ÷ 2000 Hz)</b>	≤ 100 m/s <sup>2</sup> (IEC 60068-2-6)				
<b>Shock (6 ms)</b>	≤ 1,000 m/s <sup>2</sup> (IEC 60068-2-27)				
<b>Weight (without cable)</b>	Approx. 0.08 kg (0.04 lb)				
<b>Rotor moment of inertia</b>	≤ 1 · 10 <sup>-6</sup> kgm <sup>2</sup>				
<b>Starting torque</b>	≤ 0.002 Nm				

\*for best accuracy, operating outside 0°C...+50°C is not recommended

How to Order		
RS 36XX	-XXXX	-X
<b>Model</b> <ul style="list-style-type: none"> <li>• RS 3600</li> <li>• RS 3601</li> <li>• RS 3602</li> <li>• RS 3605</li> <li>• ...</li> </ul>	<b>Line count</b> <ul style="list-style-type: none"> <li>• 1000, 1024, 2048, 2500, 3600</li> </ul>	<b>Outlet type</b> <ul style="list-style-type: none"> <li>• C - housing connector</li> <li>• 1 - 1m cable</li> <li>• 2 - 2m cable</li> <li>• 3...</li> </ul>